



DAYCO®

DAYCO AFTERMARKET TECHNICAL INFORMATION

Subject: KTBA261 / KTBA261P

N° : TI0163EN

Release 18/03/15

OPEL - VAUXHALL
ASTRA – CORSA – MERIVA – SIGNUM – VECTRA – ZAFIRA
Mtr. A16LET - Z16LEL /LER /LET /XEP /YNG – Z18XER

The KTBA261 timing kit includes:

- a **timing belt 94974** with 146 teeth, 24 mm wide
- a **tensioner KT175**
- an **idler KI90**

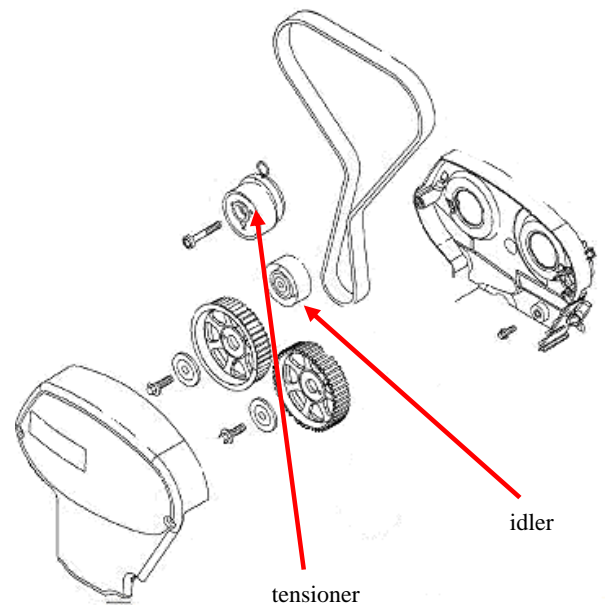

tensioner



idler

"PLEASE FOLLOW THE INSTRUCTIONS OF THE VEHICLE MANUFACTURER"

© Dayco Australia Pty Ltd. is the exclusive owner of this document. Any right of publishing, using and reproducing this document is exclusively reserved to DAYCO Australia Pty. Ltd. 2015.

www.dayco.com.au

ASSEMBLY AND TENSIONING PROCEDURE

- Install the new idler and the new tensioner
- Rotate the tensioner pulley clockwise until the locking pin is inserted (tool KM-6333), see Fig. 1.
- Make sure the timing notches A and B are aligned.
- The camshaft sprockets have been previously fastened using the appropriate tool (KM-6340-left, KM-6340-right) as in Fig. 2 .
- Position the new timing belt anticlockwise, starting from the crankshaft pinion.
- Remove the tensioner locking pin (tool KM-6333).
- Remove the camshaft aligning tool (KM-6340-left, KM-6340-right).
- Rotate the crankshaft by two turns in the direction of rotation until the TDC of Cylinder no. 1.
- Make sure the timing notches in B are aligned.
- Refit the camshaft aligning tool KM-6340-left, KM-6340-right).
- Make sure the notches A are aligned.
- Reassemble the other components in the reverse order of disassembly.
- Install the flywheel locking tool KM-911.
- Install the new bolt of the crankshaft pulley and tighten it to a torque of $95 \text{ Nm} + 30^\circ + 15^\circ$.
- Remove the flywheel locking tool (KM-911) and fit a blanking plug (Fig. 3).

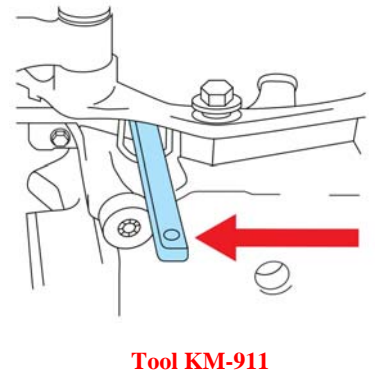
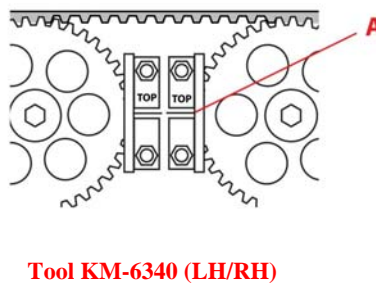
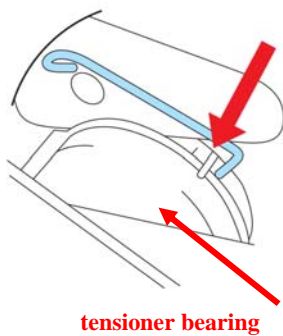
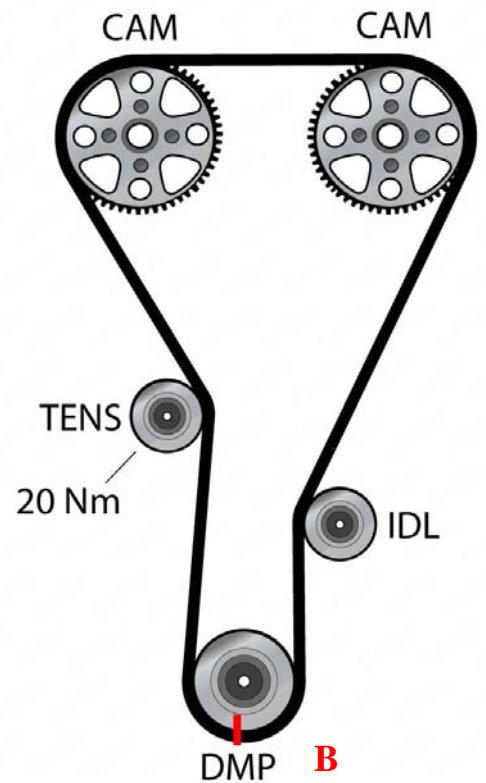

Fig. 1

Fig. 2

Fig. 3

Description	Dayco n°	Dayco Kit
Timing belt	94974	KTBA261
Tensioner	KT175	
Idler	KI90	
Seal Kit	KS82	KTBA216P
Water Pump	WP6620	